

1PLB5

Rev.1

DESCRIZIONE Piano cottura Lab incasso e filo da 90 - 4 gas + doppia corona
DESCRIPTION 90 cm Lab built-in and flush hob - 4 gas burners + double ring

PESO LORDO 20.1 Kg
GROSS WEIGHT

DIMENSIONI IMBALLO 950x580x170 mm
PACKAGING DIMENSIONS

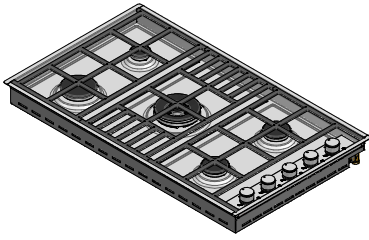

- (A) BRUCIATORE AUSILIARIO 1 kW *AUXILIARY BURNER*
- (B) BRUCIATORE RAPIDO 2.5 kW *RAPID BURNER*
- (C) BRUCIATORE DOPPIA CORONA 3.5 kW *DOUBLE RING BURNER*
- (D) BRUCIATORE SEMIRAPIDO 1.75 kW *SEMIRAPID BURNER*
- (E) BRUCIATORE SEMIRAPIDO 1.75 kW *SEMIRAPID BURNER*
- (F) ALLACCIAMENTO ELETTRICO *ELECTRICAL CONNECTION*
- (G) CONNESSIONE GAS *GAS CONNECTION*

- Acciaio Inox AISI 304 di spessore elevato (*AISI 304 extra thick stainless steel*)
- Comandi: superiori laterali integrati (*Integrated side control panel*)
- Incasso: 85x49 cm (*Cut-out: 85x49 cm*)
- Filotop: 87.3x51.3 cm (*Flush: 87.3x51.3*)

Griglie e spartifiamma in ghisa
 Cast iron pan supports and burner caps

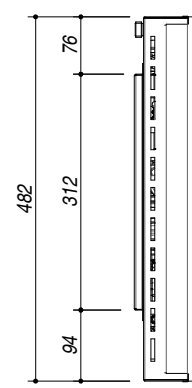
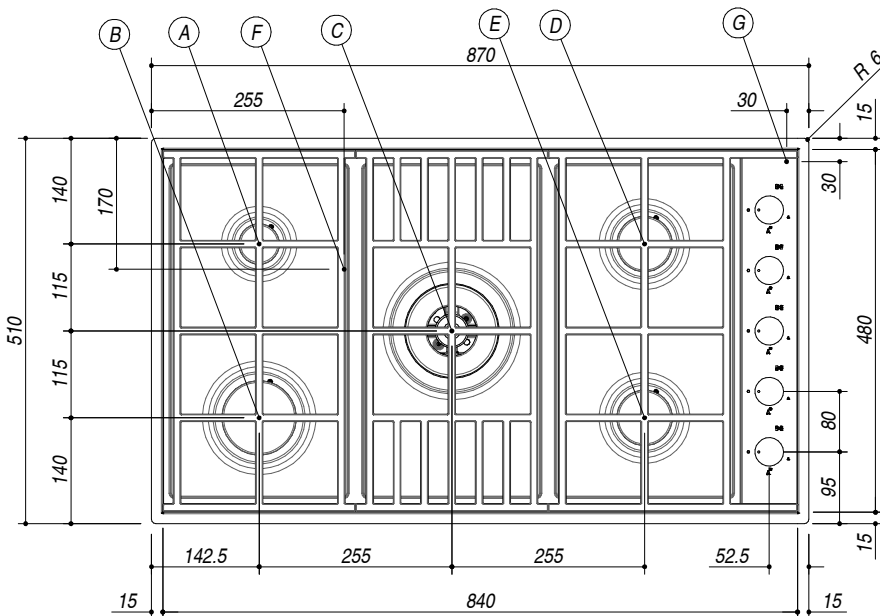
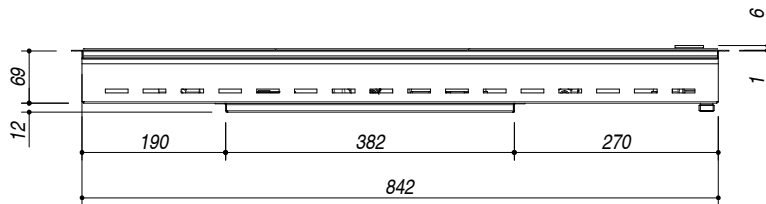

SCALA DISEGNO 1:10
DRAWING SCALE

TUTTE LE MISURE IN mm
ALL MEASURES IN mm

TOLLERANZA LINEARE: ± 0.5 mm
LINEAR TOLERANCE

TOLLERANZA ANGOLARE: ± 0.2 °
ANGULAR TOLERANCE

FORATURA PER INSTALLAZIONE AD INCASSO
BUILT-IN CUTOUT FOR TOP

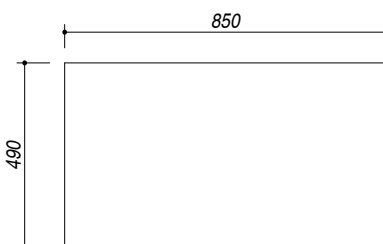

1:20

FORATURA PER INSTALLAZIONE A FILO
FLUSH CUTOUT FOR TOP

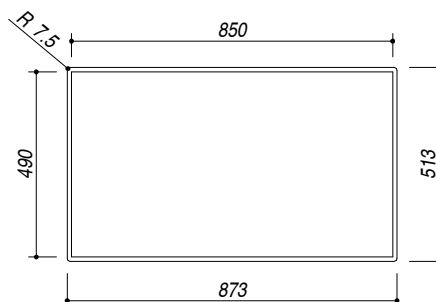

1:20

ABBASSAMENTO
LOWERING

